

Susan Spizzini



*learn*  
a language  
**embrace the world**

---

*2008 AMTESOL Conference*

MSU Riley Center  
January 18 and 19  
Meridian, Mississippi



ALABAMA-MISSISSIPPI TEACHERS OF ENGLISH TO SPEAKERS OF OTHER LANGUAGES

AMTESOL was founded in 1982, and membership is open to everyone interested in and or involved in the teaching and administration programs in English as a second or foreign language. In Mississippi we have members from various intensive English programs and public school systems in places such as Hattiesburg, Starkville, and Oxford. In Alabama our members include ESL professionals from all over the state such as Mobile, Montgomery, Tuscaloosa, Huntsville, Birmingham, Gadsden, and numerous places in-between.

AMTESOL strives to serve the needs of intensive program teachers, administrators, graduate students, and K-12 teachers in the field of ESL. Historically speaking, AMTESOL provided one of the few opportunities for ESL professionals in Alabama and Mississippi to receive local support, professional development, and opportunities to share ideas and experience. Today, AMTESOL strives to continue this service in combination with support programs that may already be in place. Over the years, members of AMTESOL have emphasized that one of the greatest benefits of membership is the connections made in the field of ESL, many of which have lasted for many years.

## **OUR MISSION**

- To collect and disseminate useful information about teaching English as a second language.
- To provide opportunities for interaction among ESL professionals.
- To identify and address TESOL problems of local, regional, and national concern.
- To stimulate professional development within the TESOL institutions of the area.
- To promote and actively support programs in local communities that will improve the teaching of English as a second language at all levels of education.
- To advocate the recognition of the specialized nature of the TESOL profession on the local, state, and national levels.

## 2007 AMTESOL EXECUTIVE BOARD

**President:** Robert D. Leier ✓  
Auburn University

**Vice President, Conference Chair** Marlynn K. Martin ✓  
Madison-Ridgeland Academy

**Vice-President, Membership:** Alison Stamps ✓  
ESL Center, Mississippi State University

**Secretary:** Heidi Goertzen ✓  
Alabama State Department of Education

**Treasurer:** Julia Austin ✓  
University of Alabama at Birmingham

**Mississippi K-12 Representative:** Esim Erdin ✓  
University of Mississippi

**Alabama K-12 Representative:** Susan Spezzini  
University of Alabama at Birmingham

**Mississippi Member-at-Large:** Molly Watkins ✓

**Alabama Member-at-Large:** Elise Harbin ✓  
Gadsden State Community College

**Past President:** Verniece Goode )  
Laurel Mississippi City Schools

**Newsletter Editor:** Carol Behel ✓  
Florence City Schools, Florence, AL 35630

**Website:** Lifei Ji ✓

# MSU RILEY CENTER

*First Floor*

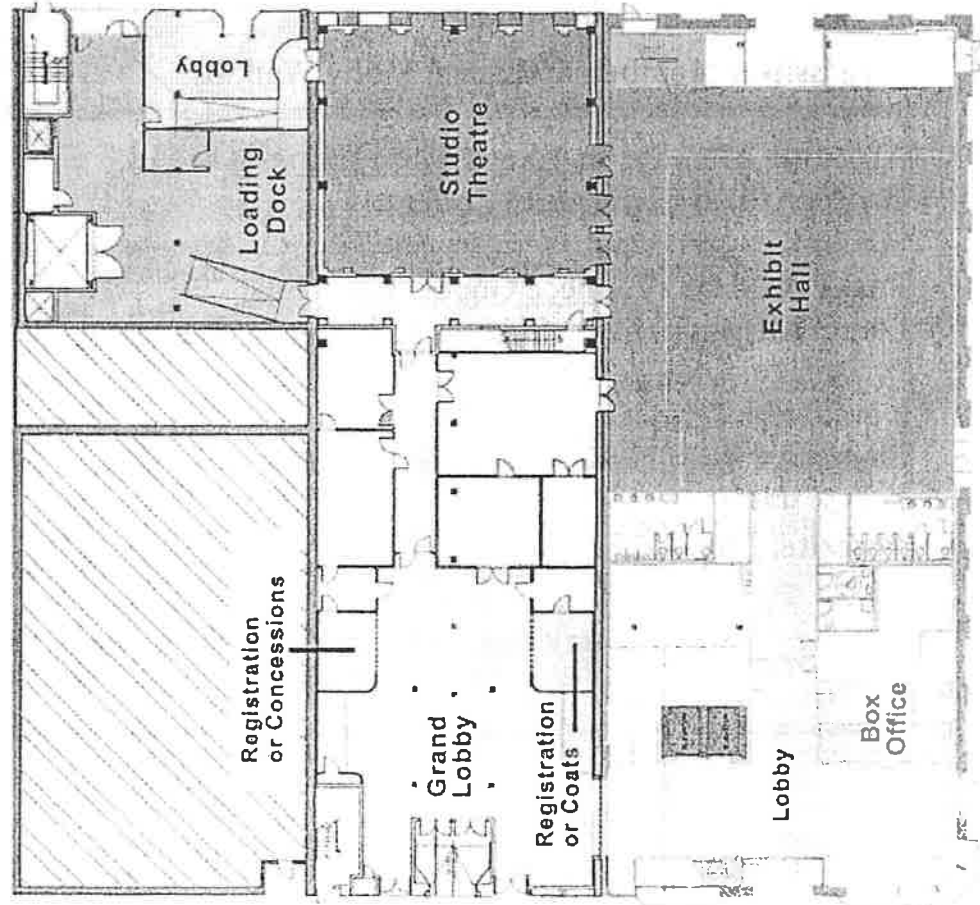

*Second Floor*

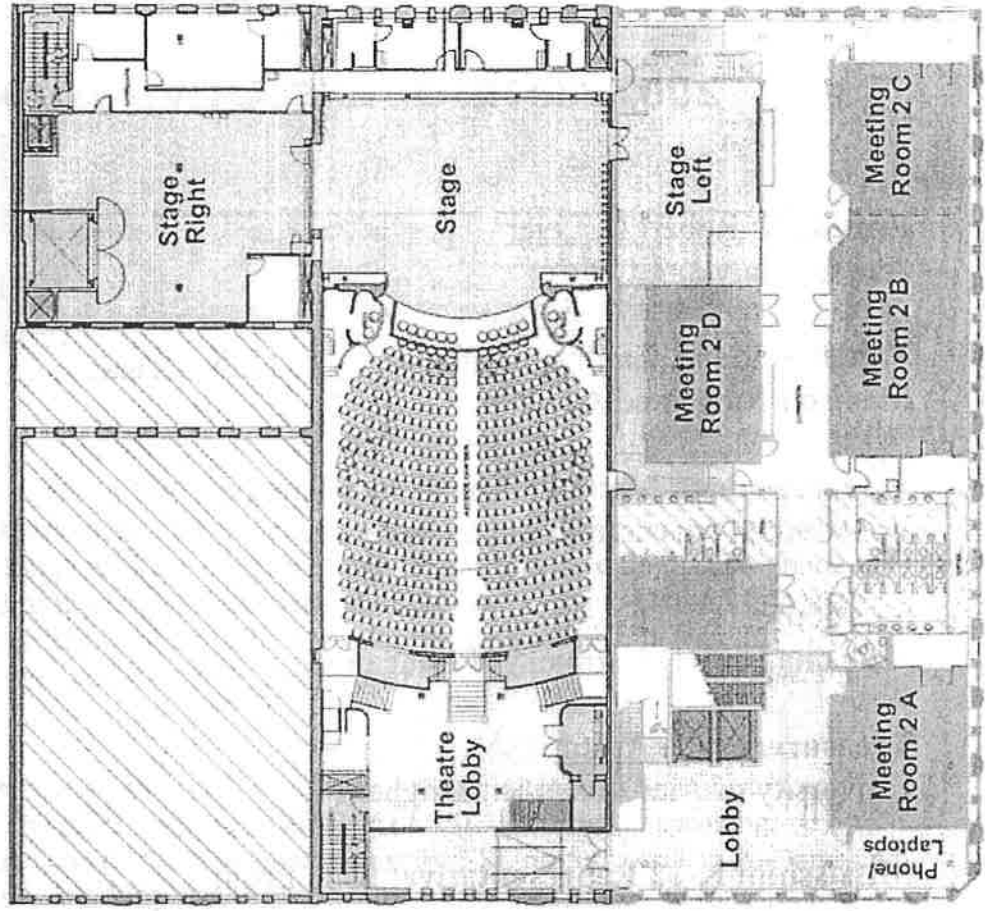

# MSU RILEY CENTER

Third Floor

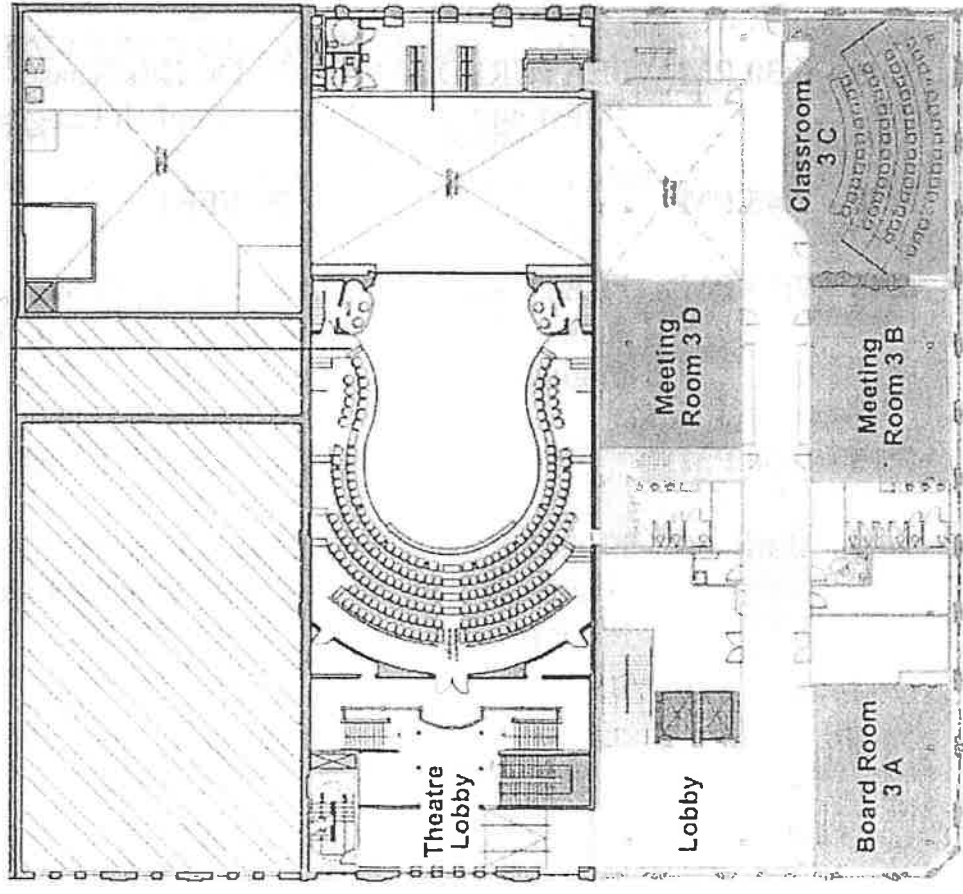

Fourth Floor

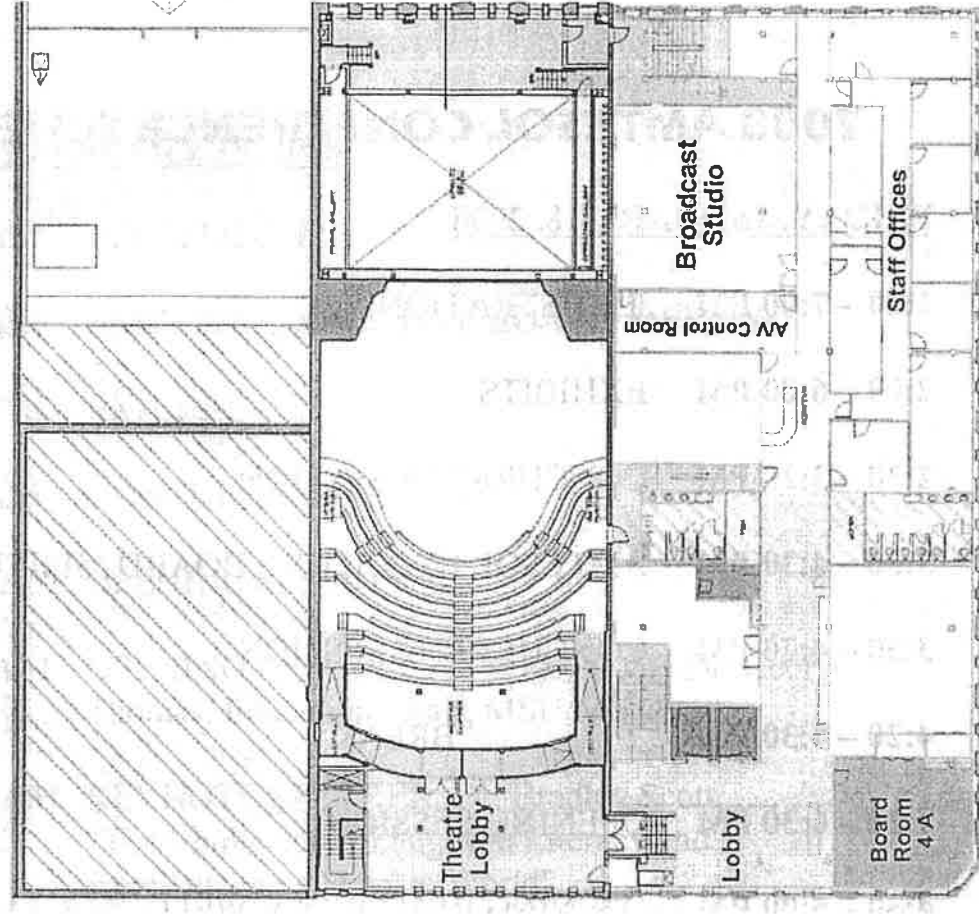

## **2008 AMTESOL CONFERENCE SCHEDULE**

### **FRIDAY, JANUARY 18, 2008**

- |                       |   |
|-----------------------|---|
| <b>1:00 – 7:00 PM</b> | <b>REGISTRATION</b>   |
| <b>2:00 – 6:00 PM</b> | <b>EXHIBITS</b>   |
| <b>2:30 – 3:20 PM</b> | <b>CONCURRENT SESSION</b>   |
| <b>3:30 – 4:30 PM</b> | <b>AMTESOL EXECUTIVE BOARD MEETING</b>  |
| <b>3:30 – 4:20 PM</b> | <b>CONCURRENT SESSION</b>   |
| <b>4:20 – 4:30 PM</b> | <b>BREAK</b>  |
| <b>4:30 – 6:30 PM</b> | <b>OPENING SESSION</b>  |
| <b>4:30 – 5:00 PM</b> | <b>OPENING REMARKS &amp; WELCOME- Meridian Mayor<br/>John Robert Smith</b>  |
| <b>5:00 – 5:45 PM</b> | <b>FEATURED SPEAKER: Dr. Carol Johnson✓<br/>“A Labor of Love”</b>   |
| <b>5:45 – 6:30 PM</b> | <b>FEATURED SPEAKER: Dr. Kris Kaase<br/>“Meeting the Challenge of English Language Learners”</b>  |
| <b>6:30 – 7:45 PM</b> | <b>DINNER BUFFET</b>  |
| <b>6:45 – 7:15 PM</b> | <b>FEATURED SPEAKERS: Dr. Beth Stapleton and<br/>Ashley Thomas “Cultural Crossroads in Teaching<br/>English: Experience in the Field”</b> |
| <b>7:15 – 7:30 PM</b> | <b>COFFEE &amp; DESSERT BREAK</b>   |
| <b>7:30 – Until</b>   | <b>FEATURED SPEAKER: Dr. Charlotte Tabereaux<br/>History &amp; Tour of the Riley Center &amp; Entertainment<br/>(door prizes)</b>         |

**SATURDAY, JANUARY 19, 2008**

**7:30 – 9:30 AM**    REGISTRATION

**8:00 – 9:00 AM**    AMTESOL EXECUTIVE BOARD MEETING

**7:30 – 12:30 PM**   EXHIBITS

**8:30 – 9:20 AM**    CONCURRENT SESSION

**9:30 – 10:35 AM**   OPENING SESSION

**9:30 – 9:45 AM**    OPENING REMARKS & WELCOME-Dr. George  
Thomas, Education Chair, MSU/Meridian

**9:45 – 10:35 AM**   KEYNOTE SPEAKER: Dr. Bradley Scott,  
“The Challenge of Language Literacy and  
Excellence in a Diverse World”

**10:35 – 10:50 AM**                      BREAK

**10:50 – 11:40 AM**   CONCURRENT SESSION

**11:40 – 12:30 PM**   CONCURRENT SESSION

**12:30 – 2:00 PM**                      LUNCH BUFFET  
AMTESOL Business Meeting  
(door prizes)

# 2008 AMTESOL Concurrent Sessions At-a-Glance

**FRIDAY, JANUARY 18, 2008**  
**2:30 pm.-3:20 pm.**

**MSU Riley Center  
Meeting Room**

- |   |                  |
|---|------------------|
| <p><i>ESL in a Mississippi School District: A Challenge like No Other</i><br/> <b>Giovani Lopez</b>, Lamar County School District, Mississippi<br/> <b>Scott Nyary</b>, Lamar County School District, Mississippi<br/> <b>Tobi Taylor</b>, Lamar County School District, Mississippi</p>  | <p><b>2B</b></p> |
| <p><i>Making Sense of AYP</i><br/> <b>Debra L. Meibaum</b>, SEDL's Southeast Comprehensive Center</p>   | <p><b>3B</b></p> |
| <p><i>IEP Students Learn a Language: TESOL Students Embrace the World</i><br/> <b>Mary S. Diamond</b>, Auburn University, IEP<br/> <b>Robert D. Leier</b>, Auburn University, ESOL Program<br/> <b>Seval Gomez</b>, Auburn University, ESOL Program<br/> <b>Alison Golz</b>, Auburn University, IEP/ESOL Program<br/> <b>Stephanie Vazquez-Castillo</b>, ESOL Program</p> | <p><b>3C</b></p> |
| <p><i>They Know More Than They Realize-Activating Students' Background Knowledge</i><br/> <b>Maci Daugherty</b>, University of Alabama, English Language Institute</p>  | <p><b>2C</b></p> |
| <p><i>By Choice-Not Force: The Evolution of a Physics Teacher and Classroom-</i><br/> <b>Cindy Hunt</b>, Auburn High School</p>   | <p><b>2A</b></p> |
| <p><i>We're in Great Shape: Making Connections through Visual Patterns-</i><br/> <b>Vicki Latham</b>, Spann Elementary, Jackson Public Schools</p>  | <p><b>3D</b></p> |
| <p><i>Create a Blog – Embrace the World : Using ESL Class Blogs</i><br/> <b>Daniela Munca</b>, University of Mississippi</p>  | <p><b>3A</b></p> |
| <p><i>Learn More about Brazil</i><br/> <b>Camila Aparecida Serafim</b>, Universidade Federal de Vicosa</p>  | <p><b>2D</b></p> |
| <p><i>Shurley English</i><br/> <b>Michelle Brown</b>, Kosciusko School District<br/> <b>Cassandra Fulton</b>, Kosciusko School District</p>   | <p><b>4A</b></p> |

**FRIDAY, JANUARY 18, 2008**  
**3:30 pm.-4:20 pm.**

**MSU Riley Center  
Meeting Room**

- |   |                  |
|---|------------------|
| <p><i>Literature Circles 101</i><br/> <b>Allison Alexander</b>, Boaz Middle School<br/> <b>Charles Zeller</b>, Boaz Middle School</p> | <p><b>3A</b></p> |
|---|------------------|



<i>NCLB Requirements in a Nutshell</i> Maggie Rivas, SEDL SECC	3C
<i>Learning from My Students: Seven Habits of Successful Academic Writer</i> Jennifer L. Greer, University of Alabama	2B
<i>Building Background by Constructing Connections</i> Anne Matheny, Spann Elementary School, Jackson Public Schools	2C
<i>Plagiarism in ESL Students' Writings</i> Steffi Kny, University of Alabama	3D
<i>Extensive Reading with the Oxford Bookworms Library</i> Amy Hegi, Specialist for Oxford University Press	2A
<i>Math, Science, WIDA: First Grade ELLs Learn Academic Language</i> Josie Prado, University of Alabama	3B
<i>The Arbitrary Use of Locative Prepositions in English: Help for English Language Learners</i> Pilar Guinazu-Walker, University of Alabama	2D

**SATURDAY, JANUARY 19, 2008**  
**8:30 am.-9:20 am.**

**MSU Riley Center  
Meeting Room**

<i>Making Sense of AYP</i> Debra L. Meibaum, SEDL's Southeast Comprehensive Center	3B
<i>Want to Know More About Achieving National Board Certification in English as a New Language?</i> Anne Betbeze, Birmingham City School and University of Alabama	3C
<i>Accommodations for Helping ELLs in High School Math</i> Veronique-Zimmerman-Brown, University of Alabama	2A
<i>High School ELL: Unique Challenges, Potential Solutions</i> Jenny Harvey, Homewood High School Amy Wood, Homewood High School	3A
<i>Effectively Teaching ELL Students</i> Bobbie Smothers-Jones, University of Mississippi	2D
<i>Motivating K-2 ELL Students to Become Confident Readers through Interactive Reading</i> Kelly Hill, Inverness Elementary School	2C

*The ESL Depot: You Can Do It! We Can Help!* 2B  
 Alisa Murphy, Teacher, Foley High School  
 Susan Blazer, Teacher, Shades Valley High School

*Accelerated Reader for the English Language Learner* 3D  
 Leslie R. Cuyuch, Workman Middle School

**SATURDAY, JANUARY 19, 2008**  
**10:50 am.-11:40 am.**

**MSU Riley Center  
 Meeting Room**

*How Many Words Do You Need to Read?* 3C  
 Carol M. Johnson, Renaissance Learning

*Rx for Treating Persistent Pronunciation "Ailments"* 3D  
 Karen Snyder, Auburn City Schools, Auburn, Alabama  
 Susan Spezzini, University of Alabama at Birmingham

*Sheltered Instruction in the Secondary Setting* 2A  
 Mary Earley, Shelby County Schools, AL  
 Elaine Mitchell, Oak Mountain High School, Shelby County Schools, AL  
 Anita Skelton, Thompson Middle School, Shelby County Schools, AL

*Experiences from a Cohort of Mainstream Teachers taking an ESOL Graduate Course*  
 Robert D. Leier, Auburn University, ESOL Program 3B

*Technology Out of the Classroom: Tying Into Students' Online Lives* 3A  
 David Laurence, University of Alabama English Institute

*What Every ELL Teacher Should Know About Second Language Acquisition?* 2B  
 Esim Payne, University of Mississippi  
 Jim Payne, University of Mississippi

*ESL in a Mississippi School District: A Challenge like No Other* 2C  
 Giovanni Lopez, Lamar County School District, Mississippi  
 Scott Nyary, Lamar County School District, Mississippi  
 Tobi Taylor, Lamar County School District, Mississippi

*A Corpus Study of English Linking Adverbials and Pedagogical Implications* 2D  
 Dilin Liu, University of Alabama

**SATURDAY, JANUARY 19, 2008**

**11:40 am.-12:30 am.**

**MSU Riley Center  
Meeting Room**

11:45  
*Mississippi Teachers Express Concern for English Language Learners*

Paula B. Mathis, University of Mississippi

3C

*Reaching the Parents of Our Middle School ELLs*

Julie Caine, Montevallo Middle School, Shelby County, AL

Jonathan Sanford, Montevallo Middle School, Shelby County, AL

2A

*Coming Out of the ELL Closet into a Classroom*

Monica D. Coe, Walker County Board of Education, Jasper, AL

2D

*Synchronous and Asynchronous Computer-Mediated Language  
Development in ESOL Classrooms*

Laureen A. Fregeau, Ph.D., University of South Alabama

Robert D. Leier, Ph.D., Auburn University, ESOL Program

2B

*The Oxford Dictionary of American English: Not the Usual A to Z*

Amy Hegi, Specialist for Oxford University Press

3D

*Using Free Online Corpora to Teach Vocabulary and Grammar*

Dilin Liu, University of Alabama

2C

*Lessons from Disaster*

Bill Powell, University of Southern Mississippi

Chris Miles, University of Southern Mississippi

3A

*Embracing Cultural Diversity*

Susan Spezzini, University of Alabama at Birmingham

Julia Austin, University of Alabama at Birmingham

3B

**SATURDAY, JANUARY 19, 2008**

**11:40 am.-12:30 am.**

**MSU Riley Center  
Meeting Room**

11:45  
*Question the Experts*

Joy Brown, University of North Alabama

Scott Nyary, Lamar County School District, Mississippi

Jewel Kastrantas, Biloxi School District

Preselfannie W. McDaniels, Jackson State University

Doris Jackson, Madison County School District

Chimene Gecewicz, University of Southern Mississippi

Maggie Rivas, SEDL SECC

Esim Payne, University of Mississippi

Beth Stapleton, Mississippi College

Mei-Chi Chen Piletz, Jackson State University

4A

## **FEATURED SPEAKER:**

### **Dr. Carol Johnson**



In 1983, at the age of 30, Carol Johnson's world was suddenly turned upside down. Her son, Justin, was born six weeks premature. He came home weighing four pounds and, after he struggled to reach the age of 10 months, Carol was told Justin had cerebral palsy and that he was brain damaged. Ignoring the expert's words that her son would be incapable of doing anything, Carol began to develop systems to counter his disabilities and to educate Justin. What she ultimately performed, some say, was a miracle. Through countless hours of patient trial and error, her son began to learn. Ultimately, her persistence and vision led to the creation of a revolutionary advance in second-language acquisition and teaching, and the Renaissance Learning™ software that is now known as English in a Flash™.

Carol Johnson is a bilingual educator. In addition to 11 years of teaching experience, Carol holds a Ph.D. in Second Language Acquisition & Teaching, specializing in how people learn second languages. A Senior Product Consultant for Renaissance Learning, she conducts research in schools nationwide.

## **FEATURED SPEAKER:**

### **Kris Kaase, Ph.D.**

Kris Kaase is the Associate Superintendent for Academic Education for the Mississippi Department of Education. In this capacity, he oversees curriculum, reading, special education and the statewide assessment program. He joined the Mississippi Department of Education 2002. Dr. Kaase has had a wide variety of experiences involving testing, evaluation, research, and school accountability at the school district, state department, and university levels in South Carolina, North Carolina, and Mississippi. He has made numerous presentations at the state, regional, and national levels. In addition to his state leadership, Dr. Kaase serves on the Assessment Task Force for the National Center for Education Statistics and on the planning committee for the National Student Assessment Conference. He has a varied educational background in philosophy, educational administration, and sociology.

## FEATURED SPEAKERS:

### **Dr. Beth Stapleton and Ashley Thomas**

Beth Stapleton is originally from Alamo, GA. She received her Bachelor of Arts in Spanish and Business Communications from Mississippi College and her Master of Arts in Spanish from the University of Mississippi. Beth taught high school in GA for five years before continuing her graduate work. She received a Ph.D. in Linguistics from Louisiana State University in 2004. Beth currently serves as department Chair in the Department of Foreign Languages at Mississippi College, as well as program director for the Master's program in TESOL.



Dr. Beth Stapleton

Ashley Thomas is originally from Cato, MS. She received her Bachelor of Arts in History and Music from Belhaven College. She has a Master of Science in TESOL from Mississippi College. Ashley has taught English in the Intensive English Program at Mississippi College and overseas in Chifeng, China. She currently serves as the Coordinator of Residence Life at M.C. and teaches adjunct courses in the Department of Foreign Languages.



Ashley Thomas

## **FEATURED SPEAKER:**

### **Dr. Charlotte Tabereaux**

Dr. Charlotte B. Tabereaux is the Education Director for the Mississippi State University Riley Center for Education and the Performing Arts in Meridian, MS, and former Executive Director of the Mississippi Arts & Entertainment Center. She is currently the Past-President of the Mississippi Alliance for Arts Education, an affiliate of the Kennedy Center Alliance for Arts Education. She is currently serving a three-year term on the National Leadership Committee for the KCAAEN. Charlotte received a Ph.D. in Education Administration from Mississippi State University in 2002.



Charlotte taught English, drama, and speech for 20 years; for ten years she served as an administrator, in positions including principal, state department senior education specialist, director of curriculum, director of federal programs and arts supervisor. Dr. Tabereaux was also an adjunct professor of English at the University of Louisville (Kentucky), in the educational leadership doctoral program at Mississippi State University, and in the master's teaching degree program at Belhaven College. She co-authored a book, Learning to Read Through the Arts K-2 in 2003 and is a former field advisor for the Mississippi Arts Commission's Whole Schools Initiative. The "Arts Across the Curriculum" program that she developed earned the Rankin County School District the 2004 Governor's Award for Excellence in the Arts. In 2004, she was named by the Mississippi Business Journal as one of the 50 Leading Business Women of Mississippi.

Charlotte's husband, Tom, is the president of Junior Achievement, Inc. of Mississippi. They have two sons: Jason, a graduate of the University of Mississippi, and Kevin, a senior at Mississippi State University.

## KEYNOTE SPEAKER:

### Bradley Scott, Ph.D.

*Senior Education Associate, Division of  
Professional Development  
Intercultural Development Research Association*



Bradley Scott, Ph.D., an IDRA senior education associate, brings 36 years of experience to the field of education. At IDRA, he serves as director of the IDRA equity assistance center, the South Central Collaborative for Equity. He has conducted training and provided technical assistance in race and human relations, intrapersonal and interpersonal communication, management styles, leadership skills, excellence and equity in education, conflict resolution, team building and embracing diversity in school settings, gender equity, and national origin equity. His broad background has been instrumental in his present capacity where he provides technical assistance and training to public school districts, school personnel, students in those schools, parents and community persons in the development and implementation of race desegregation plans, including assistance in coping with educational issues emerging from the desegregation process. The center works with school districts in Texas, New Mexico, Louisiana, Oklahoma and Arkansas, in the preparation and adaptation of desegregation plans; community, parent and student involvement in the desegregated school setting; development of equal employment procedures and policies; establishment of nondiscriminatory policies; elimination of racially bias curricular materials, and the creation of alternative materials development of human relations activities to promote racial harmony in public schools.

Dr. Scott has authored and co-authored numerous publications at IDRA including *Magnet Schools: Pockets of Excellence in a Sea of Diversity* and *It's a Matter of Race: Race Relations in a Desegregated Setting*. He also co-authored IDRA's gender equity curriculum for middle school students, *Minority Women in Science: Forging the Way*.

Dr. Scott earned his doctor of philosophy with a concentration in educational administration from the University of Texas at Austin. He received a bachelor's degree in French and education from Grove City College in Pennsylvania and a master's degree in early childhood and elementary education from the University of Texas at San Antonio.



## **SPECIAL RECOGNITION**

The centerpieces on the tables are the artwork of Northeast Middle School Artistically Gifted students. The multicultural children were actually created for a *Holiday Window Competition*

in Meridian with the theme "*All I Want for Christmas*". The figures were displayed telling Santa that all they wanted for Christmas was "world peace". Northeast Middle School won "Best of Show" for their entry.

The other multicultural centerpieces were part of the original holiday window scene as ornaments and now have been elaborated upon to become the centerpiece you see today.

Special thanks to Northeast Middle School, principal Billy Burnham; artistically gifted teacher, Sarah Cook; and the Lauderdale County School District and Superintendent Randy Hodges.

## **SPECIAL RECOGNITION**

The Leake County Public School District in Mississippi has provided the wonderful refreshments for the Saturday morning break. The Leake County School District stands by its objective to improve the educational opportunities for all learners. 100% student success is not a goal but a priority.

Their mission is to maximize and accelerate the educational benefit of all students whose primary language is not English. The district promotes a high-quality education that is both nurturing and demanding. All students can learn but at dissimilar rates and in various ways.

The mission of this district is the shared responsibility of the students, parents, teachers, other school staff, the board of education, and the community. Special thanks to the Leake County School District and Superintendent Monte Ladner.

## **SPECIAL RECOGNITION**

Special thanks to Rebecca Davis-Kelly, Assistant Professor of Graphic Design/College of Architecture, Mississippi State University, for creating the logo design for the 2008 AMTESOL Conference program and tote bags. We appreciate your artistic contribution in support of the 2008 AMTESOL Conference.

## VENDORS & PUBLISHERS

Adams Learning Resources, LLC  
338 Highland Park Drive  
Birmingham, AL 35242-6837  
Darrell Adams  
[dadams@adamslearningresources.com](mailto:dadams@adamslearningresources.com)  
205-980-2506

Cambridge University Press  
32 Avenue of the Americas  
New York, NY 10013  
James Anderson  
[janderson@cambridge.org](mailto:janderson@cambridge.org)  
212-337-5008 (phone)  
212-645-5960 (fax)

Lakeshore Learning Materials  
2695 E. Dominguez St.  
Carson, CA 90895  
Darryl Thomas  
[Dthomas@lakeshorelearning.com](mailto:Dthomas@lakeshorelearning.com)  
800-421-5354 (phone)  
310-632-8314 (fax)

Oxford University Press  
198 Madison Avenue  
New York, NY 10016  
Amy Hegi  
[monique.jackson@oup.com](mailto:monique.jackson@oup.com)  
212-726-6313

Pearson Longman  
Pearson Education  
10 Bank Street, Suite 900  
White Plains, NY 10606  
Anna Rowen, Representative  
Barbara McIntosh, Conference Coordinator  
[barbara.mcintosh@pearsoned.com](mailto:barbara.mcintosh@pearsoned.com)  
914-287-8059

Teachers 'N Tools, Inc.  
3954 Demetropolis Road  
Mobile, AL 36693  
Jonathan Stewart  
Courtney Conner  
Julian Phillips  
[sales@teachersntools.com](mailto:sales@teachersntools.com)  
800-826-4614

Renaissance Learning, Inc.  
108 Royal Lane  
Fairhope, AL 36532  
Andrea Shane  
[andrea.shane@renlearn.com](mailto:andrea.shane@renlearn.com)  
866-391-4355 (work)  
251-243-3473 (home)

Shurley Instructional Materials, Inc.  
Shurley English  
761 Rice Road, Legacy Apt. # 1203  
Ridgeland, MS 39157  
Gail Terry  
[msrep@shurley.com](mailto:msrep@shurley.com)  
601-940-2443

Townsend Press, Inc.  
439 Kelley Drive  
West Berlin, NJ 08091  
Maryanne Sennett  
George Henry  
[TPATNJ@aol.com](mailto:TPATNJ@aol.com)  
888-752-6410

Peak performance is easy with ESL materials by

**Elizabeth Claire**

(founder and editor,  
Easy English NEWS)

**NEW!**  
ESL Phonics for All Ages  
Easy Songs for English Language Learners  
American Manners and Customs  
Classroom Teacher's ESL Survival Kits # 1 and 2  
The New Boy is Lost! ESL Teacher's Activities Kit  
Help Your Buddy Learn English Three Little Words  
ESL Teacher's Holiday Activities Kit Dangerous English!  
What's So Funny? Just A Minute! And much more!

Visit our Website to download FREE materials you can use NOW!

**www.Elizabethclaire.com**

*Money-back Guarantee Always!*

Tel: 888-296-1090

## **SPECIAL THANKS TO:**

Jackson Convention & Visitors Bureau

Lauderdale County Chamber of Commerce

Leake County Public School District

Mississippi Tourism & Development

The 2008 AMTESOL Executive Board

The Lauderdale County Public School District

The Meridian Public School District

## **2008 CONFERENCE COMMITTEE**

Julia Austin, Ph.D. – Registration Chair

Carol Behel – Program Ads

Verniece Goode – Vendors Chair

Lifei Ji - Website

Marlynn K. Martin – Conference Chair

Paula Mathis, Ed.D. – Proposal Chair

# Join us in Birmingham, Alabama for



## September 25 - 27, 2008

### Invited Speakers

David and Yvonne Freeman, Ann Ebe, Janet Zadina, Jim and Lydia Stack,  
Carlos Cortes, Catherine Collier, Debi Strevy

### Pre-Conference Workshops

September 24

Workshops include Learning Styles, New Ideas for Teaching Pronunciation,  
and Strategies for Effective Interaction (check website for complete list of options)

### Focus Days (cost for workshops included in registration or 1-day registration available)

*K-12 Strand: Mainstream Teachers*

September 25

*Post Secondary Strand: Intensive English Programs*

*K-12 Strand: Special Education and ELLs*

September 26

*Post Secondary Strand: Higher Education Round Table*

### Concurrent Session Strands

*K-12: Elementary, Middle, Secondary, Special Education, General K-12, Teacher Training*

*Adult ESL: English for Special Purposes, International Teaching Assistants,  
Intensive English Programs, Higher Education, Research*

Conference Information and Updates:

<http://www.antesol.org>

Questions? Email: [setesol2008@yahoo.com](mailto:setesol2008@yahoo.com)

Hosted by:



AMTESOL

ALABAMA-MISSISSIPPI TEACHERS OF ENGLISH TO SPEAKERS OF OTHER LANGUAGES



## SETESOL 2008 Conference Registration Form

September 25-27, 2008 Birmingham, AL  
Pre-Conference Workshops Sept. 24, 2008

\_\_\_\_\_  
Last (Family) Name

\_\_\_\_\_  
First (Given) Name

\_\_\_\_\_  
Middle Initial

\_\_\_\_\_  
Institution, School, or Company

**Mailing Address:**

☐ Home

☐ Work (please check one)

\_\_\_\_\_  
Mailing Address

\_\_\_\_\_  
City

\_\_\_\_\_  
State

\_\_\_\_\_  
Zip/Postal Code

\_\_\_\_\_  
Phone (include Area Code)

\_\_\_\_\_  
Fax

\_\_\_\_\_  
Email Address

If you are member of a Southeast TESOL affiliate, check the appropriate box:

- ☐ AMTESOL   ☐ ARKTESOL   ☐ Carolina TESOL   ☐ GATESOL   ☐ KYTESOL   ☐ LATESOL  
☐ SSTESOL   ☐ TNTESOL   ☐ VATESOL

If a full-time student, provide one of the following as documentation:

- ☐ letter stating status from Student Accounting Office or ☐ letter stating status from faculty advisor

Please provide us with information about you:

What populations do you serve? (Check all that apply)

- ☐ Adult ELLs   ☐ ELLs in Higher Ed   ☐ ITAs   ☐ K-12   ☐ Elementary   ☐ Secondary   ☐ Migrant  
☐ Teachers in Training   ☐ Other \_\_\_\_\_

Would you be willing to volunteer at the conference? \_\_\_\_\_

If yes, when (preferred day and time)? \_\_\_\_\_

Conference updates on AMTESOL website: <http://www.amtesol.org>  
Questions? Email [setesol2008@yahoo.com](mailto:setesol2008@yahoo.com)

# **SETESOL 2008 Conference Registration** **Sept. 25-27, 2008 Birmingham, AL**

<b>Early Registration</b> (includes lunch every day) (postmarked by August 15, 2008)	\$200	_____
<b>Late or Onsite Registration</b> (Lunch included with Late Registrations but <i>not</i> guaranteed for Onsite Registrations)	\$230	_____
<b>1-Day Registration</b> (Lunch included for Pre- or Late 1-Day Registrations, not for Onsite Registrations)	\$ 70	_____
<b>Student Registration</b> (must be full-time student )	\$100	_____
<b>Pre-Conference Workshops</b> (Wed., Sept. 24)		
1 Full-day workshop (includes box lunch & break) or	\$ 60	_____
2 Half-day workshops (includes box lunch & break)	\$ 60	_____
1 Half-day workshop (includes break)	\$ 30	_____
	<b>Total</b>	_____

Make checks and Purchase Orders payable to Alabama-Mississippi TESOL (or AMTESOL) and send to the following address:

AMTESOL  
c/o Julia Austin, Treasurer  
HUC 511/UAB Graduate School  
1530 3<sup>rd</sup> Avenue South  
Birmingham, AL 35294-1150

**Note: No refunds will be given after Sept. 1, 2008. Registrations cancelled *before* Sept. 1, 2008 will be assessed a \$30 processing charge.**

## **Pre-Conference Workshops Sept. 24, 2008**

Workshops are limited to 40 participants each. Number workshops in order of preference (1, 2, etc.).  
Pre-conference registration is on a first-come basis. If for any reason, a pre-conference workshop must be cancelled, a full refund will be given.

- 1 full-day workshop     \$60 (box lunch & breaks included)
- 2 half-day workshops   \$60 (box lunch & breaks included)
- 1 half-day workshop    \$30 (break included)

- \_\_\_\_\_ WIDA ACCESS Data Workshop  
                 Wednesday Sept. 24 8:30 to 5 p.m. Workshop leader: Heidi Goertzen
- \_\_\_\_\_ Cognitive Learning Styles and Strategies in a Cross-Cultural Setting  
                 Wednesday Sept. 24 8:30 a.m. to 12:30 p.m. Workshop leader: Catherine Collier
- \_\_\_\_\_ Strategies for Effective Interaction  
                 Wednesday Sept. 24 8:30 a.m. to 12:30 p.m. Workshop leader: Susan Spezzini
- \_\_\_\_\_ Using WIDA Assessments and Standards to Enhance Instruction  
                 Wednesday Sept. 24 8:30 a.m. to 12:30 p.m. Workshop leaders: TBA
- \_\_\_\_\_ New Ideas for Teaching Pronunciation  
                 Wednesday Sept. 24 1 to 5 p.m. Workshop leader: Jonghee Shadix
- \_\_\_\_\_ Accommodations for ELLs in Secondary Content Classrooms  
                 Wednesday Sept. 24 1 to 5 p.m. Workshop leader: Veronique Zimmerman-Brown





Call for Proposals (Deadline: May 1, 2008)  
**Southeast Regional TESOL Conference**  
*Cultivating Connections, Celebrating Commonalities*  
September 25-27, 2008—Birmingham, Alabama  
<http://www.amtesol.org>

STEPS for submitting a presentation proposal:

1. Submit your presentation proposal (deadline: May 1, 2008) by email to [SETESOL2008@yahoo.com](mailto:SETESOL2008@yahoo.com) or by fax to 205-996-2220.
2. A complete presentation proposal must include two separate parts—this Call for Proposals form (Step #3) and the Abstract Page (Step #4).
3. Provide all information requested below by printing on this form, by completing this form electronically on Word, or by reproducing it in an email.
4. The second part of your presentation proposal is called the Abstract Page. Your Abstract Page must include: title of presentation, intended audience, type of presentation, audio-visual equipment needed, a 40-word description for the program book, and a 250-word abstract. This abstract must include the objectives for your presentation and an organized step-by-step description of how you plan to deliver your presentation. This information will be vital in determining whether proposed presentations are of the professional quality expected by conference attendees.
5. Within a week of submitting your proposal, the *first presenter* will receive an email indicating receipt of the proposal. If you do not receive this email, please inquire at [SETESOL2008@yahoo.com](mailto:SETESOL2008@yahoo.com). The first presenter is responsible for forwarding all correspondence to other presenters.
6. Acceptances will be emailed to the first presenter on approximately June 1, 2008. As soon as possible, you should reply via email and confirm your commitment to present. In this email, you should also mention any possible scheduling conflicts (e.g., *not available on Thursday, September 25<sup>th</sup>*).

**First Presenter**

Name:  
Institution:  
E-mail (home and/or work):  
Permission to include email in program book (yes/no):  
Telephone (cell, home, and/or work):  
Complete Mailing Address:  
Biographical Statement: (25-word limit)

**Other Presenter(s)** *Copy this section as needed.*

Name:  
Institution:  
E-mail (home and/or work):  
Permission to include email in program book (yes/no):  
Telephone (cell, home, and/or work):  
Complete Mailing Address:  
Biographical Statement: (25-word limit)

25-Word  
Description

**Title of Presentation** (9-word limit):

**Intended Audience** (mark all that apply)

☐ Elementary    ☐ ELLs in Higher Education    ☐ Intensive English Programs    ☐ Teacher Education    ☐ Migrant  
☐ Secondary    ☐ Int'l Teaching Assistants    ☐ Adult ELLs in other programs    ☐ Administration    ☐ Other: \_\_\_\_\_

**Type of Presentation** (mark one)

☐ 45 minutes: ☐ Paper (describes research or process), ☐ Demonstration (shows technique), ☐ Publisher (shows product)  
☐ 100 minutes: ☐ Workshop-style demonstration with extensive audience participation

**Audio-Visual (A/V) Needs: Requests to be Provided by Conference Organizers** (mark all that apply)

☐ Tripod with flip chart paper (presenters should bring their own markers) *and extra markers*  
☐ Overhead projector and screen *(to be provided free of charge)*  
☐ TV and VCR/DVD Player (\$35, paid by the presenter)  
☒ Video projector for PowerPoint (a limited number will be available free of charge on a first-come basis),  
**NOTE:** Because the cost of renting equipment is extremely high and would have to be covered by you—the presenter, we kindly request your collaboration with the following. If you plan to play a tape or CD, please bring your own tape recorder and/or CD player. If you plan to do a power point presentation, please bring your own laptop and projector.  
Internet access is \$300 per connection (paid by the presenter). *on audio*

**Description for Program Book:** (40-word limit):

**Abstract Page:** The Abstract Page is the second part of your presentation proposal. As described above in Step #4, it should include title of presentation, intended audience, type of presentation, A/V needs, a 40-word description for program book, and a 250-word abstract.