

*Today's ESL: It's Not Your
Granddaddy's ESL Anymore*



2005 AMTESOL Conference
University of North Alabama
Florence, Alabama
January 28-29, 2005



UNIVERSITY
of NORTH
ALABAMA

Florence, Alabama 35632-0001

*College of Education
UNA Box 5031
(256) 765-4252
Fax (256) 765-4664*

January 19, 2005

The College of Education at the University of North Alabama is pleased to serve as the host for the annual Teachers of English to Speakers of Other Languages (TESOL) conference.

Many educators have worked diligently to make this a conference that will inspire and inform us in our quest to provide quality education to the young people in our schools.

UNA has a long tradition in preparing educators and we were among one of the first institutions to offer a program preparing individuals to educate students who have English as a second language.

We hope that you enjoy the conference as you participate in the many activities that have been planned for you over the next few days.

Sincerely,

Mark Edwards, Dean
College of Education



AMTESOL

ALABAMA-MISSISSIPPI TEACHERS OF ENGLISH
TO SPEAKERS OF OTHER LANGUAGES

January 28, 2005

Greetings Friends and Colleagues!

Welcome to the 2005 AMTESOL Conference! We are very excited to be able to host this conference here at the University of North Alabama. We hope you enjoy visiting our campus and exploring the Shoals area.

The theme this year, *Today's ESL: It's Not Your Granddaddy's ESL Anymore*, focuses on how our field has changed dramatically over the years. To help us with our theme, we have a great speaker this year! Teresa O'Donnell (Terry), the Executive Director of the Commission on English Language Program Accreditation (CEA), has traveled from Texas to speak with us about her experiences in the field of ESL. We are also excited to have over 30 concurrent sessions planned for you with presenters from all over the world. There are also several publishers to help you gather great ideas and materials. We hope you will find a lot of interesting and helpful information to use in your classrooms and schools. As additional bonuses, we have arranged for entertainment from some of UNA's finest performers and a breakfast, compliments of UNA's Vice President, Dr. Daniel Howard.

As you meet with others in our field and exchange ideas, we hope you have a wonderful time! Our executive board is interested in any comments, questions, or ideas you may have either for the conference or for our organization. Please let us know if there are ways AMTESOL might better serve your needs as a professional in the field of TESOL.

Sincerely,

Joy Brown

2005 AMTESOL Conference Chair

Table of Contents

Welcome Letter	2
Table of Contents	3
AMTESOL Description	4
AMTESOL Officers	5
Conference Schedule	6
Featured Speaker	6
Conference at a Glance	7
Concurrent Sessions	10
Vendors	18
Special Thanks	19
Map of Gulliot University Center	20

Alabama-Mississippi Teachers of English to Speakers of Other Languages (AMTESOL)

AMTESOL was founded in 1982, and membership is open to everyone interested in and or involved in the teaching and administration programs in English as a second or foreign language. In Mississippi we have members from various intensive English programs and public school systems in places such as Hattiesburg, Starkville, and Oxford. In Alabama our members include ESL professionals from all over the state such as Mobile, Montgomery, Tuscaloosa, Huntsville, Birmingham, Gadsden, and numerous places in-between.

AMTESOL strives to serve the needs of intensive program teachers, administrators, graduate students, and K-12 teachers in the field of ESL. Historically speaking, AMTESOL provided one of the few opportunities for ESL professionals in Alabama and Mississippi to receive local support, professional development, and opportunities to share ideas and experience. Today, AMTESOL strives to continue this service in combination with support programs that may already be in place. Over the years, members of AMTESOL have emphasized that one of the greatest benefits of membership is the connections made in the field of ESL, many of which have lasted for years.

Purposes of AMTESOL:

- To collect and disseminate useful information about teaching English as a second language.
- To provide opportunities for interaction among ESL professionals.
- To identify and address TESOL problems of local, regional, and national concern.
- To stimulate professional development within the TESOL institutions of the area.
- To promote and actively support programs in local communities that will improve the teaching of English as a second language at all levels of education.
- To advocate the recognition of the specialized nature of the TESOL profession on the local, state, and national levels.

AMTESOL Executive Board 2004

Pres: Molly Watkins mwatkins@ce.msstate.edu
VP, Conference Chair: Joy Brown jmbrown@una.edu
VP, Membership: Alison Stamps als11@ra.msstate.edu
Secretary: Patti Wilborn pwilborn@gadsdenstate.edu
Treasurer: Julia Austin jaustin@uab.edu
Mississippi Member-at-Large: Janice Cate esol115@yahoo.com
Alabama Member-at-Large: David E Luellen dluellen@uab.edu
Mississippi K-12 Representative: Verniece Goode Benz_mom@hotmail.com
Alabama K-12 Representative: Robert Leier rdleier@zebra.net
Past President: Amy Snow asnow@gadsdenstate.edu
Newsletter Editors: Lyn Froning lfroning@uab.edu
Carol Behel cabelhel@fcs.k12.al.us
Web Site Lifei Ji lji@jackson.K12.ms.us

AMTESOL Executive Board 2005

Pres: Joy Brown jmbrown@una.edu
VP, Conference Chair:
VP, Membership:
Secretary:
Treasurer:
Mississippi Member-at-Large:
Alabama Member-at-Large:
Mississippi K-12 Representative:
Alabama K-12 Representative:
Past President: Molly Watkins mwatkins@ce.msstate.edu
Newsletter Editors: Carol Behel cabelhel@fcs.k12.al.us
Web Site:

Would you or someone you know like to serve as an AMTESOL Executive Board member? If so, please speak with one of the current AMTESOL Executive Board members. We are always searching for energetic, enthusiastic people to help our organization grow!

Conference Schedule

Friday, January 28th

2:00PM - 6:00PM - Registration
2:00 - 6:00 PM - Exhibits
3:30 - 4:15 PM - Concurrent Session I
4:20 - 5:30 PM - AMTESOL Executive Board Meeting
4:30 - 5:15 PM - Concurrent Session II
5:30 - 7:00 PM - Dinner
7:00 - 8:00 PM - Conference Opening with Plenary Speaker
8:00 - 10:00 PM Entertainment

Saturday, January 29th

7:30 - 8:30 AM - Breakfast
7:00AM - 12:30PM - Exhibits
8:30 - 9:15 AM - Concurrent Session III
9:30 - 10:15 AM - Concurrent Session IV
10:15 - 10:45 AM - Coffee/Snack Break
10:45 - 11:30 AM - Concurrent Session V
11:45 AM - 12:30 PM - Concurrent Session VI
12:30 PM - 2:00 PM - Lunch with Plenary Speaker and AMTESOL Business Meeting

Featured Speaker

Teresa O'Donnell (Terry) is the Executive Director of the Commission on English Language Program Accreditation (CEA), which accredits postsecondary English language programs in universities and colleges and independent language schools. Prior to assuming this position, she served as Director of Field Services and Deputy Executive Director of TESOL. Her responsibilities included support for TESOL affiliates, interest sections, and committees; coordination of advocacy and government relations activities; education programming; and information services. Terry has taught and had administrative experience in adult education, K-7, university, and community college ESL programs. She is the co-author of Independent Writing.

Conference at a Glance

Friday, January 28th

2:00PM - 6:00PM - Registration

2:00 - 6:00 PM - Exhibits

Concurrent Session 1 - Friday - 3:30 - 4:15PM

Room 200 - Middle School Demands and Weak or Diverse Schemas of ESL Students *Russann Wood, M. Ed., Mary Murray Stowe, M.Ed., Simmons Middle School*

Room 225 - Why Measuring Growth is Especially Important in Evaluation of English Language Learners *Marie Miller-Whitehead, University of North Alabama*

Room 207 - Formulaic Sequences in Language Processing
Tatiana Nekrasova, Nan Tiang, Georgia State University

Loft - Recruiting in Brazil: A Case Study *Alan L. Webb, University of Alabama at Gadsden; Patricia Pedrosa Botelho Universidade Federal De Viçosa; Kelem Pena Universidade Federal De Viçosa; Eliana Luiz Campbell Universidade Federal De Viçosa; Edna Frietas Lima Universidade Federal Belo Horizonte*

Performance Center - Stress Placement as a Suprasegmental Problem to Nigerian Speakers of English *Comrade Samson Olasunkanmi Oluga and Mrs. Taiwo Olukemi Oluga, Federal Polytechnic, EDE, Nigeria*

4:20 - 5:30 PM - AMTESOL Executive Board Meeting - Room 206

Concurrent Session 2 - Friday - 4:30 - 5:15PM

Room 200 - Not Just "3R's" Anymore: Entertainment Media in the Classroom *Catherine Hutcheson, Troy University*

Room 225 - Reading the ELL Classroom as Text *Charlotte L. Pass, The University of Alabama*

Room 207 - Continuity in Foreign Language Learning From Third to Sixth Grades *Grace Chin-Wen Chien, Chung-Hu Elementary School*

Loft - KEEPING IT REAL! *Terri Craft, Crystal Maness, Melissa Michael, University of North Alabama*

Performance Center - I Have an Idea; Now Where Do I Get the Money?
Amanda Perry, University of North Alabama

5:30 - 7:00 PM - Dinner - Banquet Hall A & B

7:00 - 8:00 PM - Conference Opening with Plenary Speaker

8:00 - 10:00 PM - Entertainment

Saturday, January 29th

7:30 - 8:30 AM - Breakfast - In Atrium - Hosted by Dr. Daniel Howard,
University of North Alabama's Vice President of University Advancement &
Administration

7:00AM - 12:30PM - Exhibits

Concurrent Session 3 - Saturday - 8:30 - 9:15 AM

Room 200 - Feed The Students' Souls In The Language Classroom With Music! *Seniz Bilgi,, Middle East Technical University*

Room 225 - ACTFL Rubrics for Assessing Proficiency in Reading, Listening, Speaking, and Writing *Marie Miller-Whitehead, University of North Alabama*

Room 207 - Assessing English Language Learners In ESL Or Mainstream Classrooms *Dr. Laureen A. Fregeau and Dr. Robert D. Leier, University of South Alabama*

Loft - Avenues to Language and Literacy Success
Rebecca Gigliotti, Hampton-Brown Co.

Performance Center - Now What Do I Do? Practical Tips for Teachers of ELLs *Anna Pérez-Melvin, Russellville High School*

Concurrent Session 4 - Saturday - 9:30 - 10:15 AM

Room 200 - HELP! Helping English Language Learners Progress
Vicki Davidson, Division Director/Title III State Director, Mississippi Department of Education

Room 225 - What Makes a Successful ELL Program *Marlynn Martin, Rankin County School District*

 **Room 207 - Walk a Mile in My Shoes: Teaching Tolerance in ESL**
Dr. Susan Olmstead, University of Alabama, Huntsville

Loft - Life is Full of Barriers. English Should Not Be One
Matt Adams, Darrell Adams, Dorothy Adams, Adams Learning Resources

Performance Center - What's In The Newspaper? *Sheryl Stewart, Hoover High School*

10:15 - 10:45 AM - Coffee/Snack Break

Concurrent Session 5 - Saturday - 10:45 - 11:30 AM

Room 200 - Challenges facing ELLs based on their L1 writing systems *Susan Spezzini, University of Alabama at Birmingham*

Room 225 - Working with ELL Students in the Mainstream Classroom
Carol Behel, Florence City Schools (K-9)

Room 207 - Fundamentals of Grant Writing *Pricilla Holland, Ed.D., University of North Alabama*

Loft - What Everyone Needs to Know About Recruiting
Alan L. Webb, The University of Alabama at Gadsden

Performance Center - Teaching Uncountable Nouns to Portuguese Speakers *Eve Ribeiro, Georgia State University*

Atrium - Tour of UNA Campus - Learn more about UNA and see our beautiful campus. Visit with our mascots Leo and Una.

Concurrent Session 6 - Saturday - 11:45 AM - 12:30 PM

Room 200 - Latest & Greatest from Oxford University Press
Cindy Tracy, World of Reading – Ala. Rep. for Oxford University Press

Room 225 - WIDA Standards and Assessments for English Language Learners in Kindergarten through Grade 12 *Dely Velez Roberts, Alabama Department of Education, Title III Coordinator*

Room 207 - Word length effect on the retrieval process of L2 writing *Tony Becker, Georgia State University*

Loft - Teaching English While Learning Different Cultures
Cagri, Bagcioglu, Tugrul Polat, Millie Nelson, University of North Alabama

Performance Center - What did you say? Analyzing Discourse in Listening/Speaking Classrooms *Alice Cook, University of North Alabama*

Atrium - Tour of UNA Campus - Learn more about UNA and see our beautiful campus. Visit with our mascots Leo and Una.

12:30 PM - 2:00 PM - Lunch with Plenary Speaker and AMTESOL Business Meeting - Banquet Hall A & B

AMTESOL Concurrent Sessions

Concurrent Session 1 - Friday - 3:30 - 4:15PM

Room 200 - Middle School Demands and Weak or Diverse Schemas of ESL Students *Russann Wood, M. Ed., Mary Murray Stowe, M.Ed., Simmons Middle School*

Students in middle school are expected traditionally to arrive with a specific set of skills in place to begin the new level of work. It is not expected that basic reading skills, reading comprehension, or learning strategies need to be taught and further developed to create the prior background knowledge necessary to comprehend the material. How do we handle this opportunity? **Audience:** Administration, Teacher Education

Mary Murray Stowe is a teacher at the middle school level. She was educated at James Madison University and the University of North Carolina at Chapel Hill and studied with Dr. Mel Levine. Russann Wood currently teaches at the middle school level. She was educated at the University of Montevallo, MED, and the University of Alabama at Birmingham, MA, collaborative Teaching K-6 & 6-12. E-mail: ruwood@hoover.k12.al.us; mstowe@hoover.k12.al.us

Room 225 - Why Measuring Growth is Especially Important in Evaluation of English Language Learners *Marie Miller-Whitehead, University of North Alabama*

This presentation examines current practices in the assessment of ESL students and provides examples of criterion and norm-referenced measures. The author concludes that multiple measures are invaluable for ELL assessment and that measures of student growth or gain should be a component of the evaluation of ESL students. A case study will be included in this session. **Audience:** K-12, Higher Education, Research, Teacher Education

Marie Miller-Whitehead has taught EFL in Venezuela, has conducted bilingual training for a multinational corporation, and has published several articles and reviews on testing and assessment issues. She has designed assessments for Kindergarten, secondary, and college level students.

Room 207 - Formulaic Sequences in Language Processing
Tatiana Nekrasova, Nan Tiang, Georgia State University

The experiment tested whether formulaic sequences are processed differently from nonformulaic phrases of similar length and frequency using an on-line grammaticality-judgment task. The findings showed that formulaic phrases were responded to significantly faster than generated phrases by both groups (native and nonnative speakers) **Audience:** Research

Tatiana Nekrasova is a graduate student at the Department of Applied Linguistics & ESL, Georgia State University. Nan Tiang, Ph.D. is an Assistant Professor at the Department of Applied Linguistics & ESL, Georgia State University E-mail: netami2002@mail.r4

Loft - Recruiting in Brazil: A Case Study *Alan L. Webb, University of Alabama at Gadsden; Patricia Pedrosa Botelho Universidade Federal De Viçosa; Kelem Pena Universidade Federal De Viçosa; Eliana Luiz Campbell Universidade Federal De Viçosa; Edna Frietas Lima*

Learn how the theoretical principles and techniques of recruiting were applied in an actual recruiting trip to Brazil. Also meet and establish recruiting relationships with four of Brazil's future education leaders. **Audience:** Research, Higher Education, Administration, Intensive English Programs, Teacher Education

Alan Webb recently graduated from Shenandoah University with his master's degree in TESOL. His thesis was entitled "Marketing and Recruiting for the IEP." E-mail: webb81357@yahoo.com.

Performance Center - Stress Placement as a Suprasegmental Problem to Nigerian Speakers of English Comrade Samson Olanikanmi Oluga and Mrs. Taiwo Olukemi Oluga, Federal Polytechnic, EDE, Nigeria

This paper presents the outcome of a study of word stress placement in speeches of selected Nigerian teachers, broadcasters, preachers, and commentators using English as a second language. The study discovered that they have difficulties in the area of suprasegmental phonology of English than others: The study identifies likely causes and effects, and suggests panacea. **Audience:** Higher Education, Teacher Education

Comr. S.O. Oluga, TESOL, USA member (10185) Chair, Academic Staff Union, English Lecturer (1992-2004); **Mrs. Taiwo Olukemi Oluga**, TESOL, USA Member (101885 Joint) Business English Lecturer (2000-2004)

Concurrent Session 2 - Friday - 4:30 - 5:15PM

Room 200 - Not Just "3R's" Anymore: Entertainment Media in the Classroom Catherine Hutcheson, Troy University

Popular culture and entertainment forms are useful tools for language acquisition. This multimedia demonstration with handouts shows ways to use cartoons ("Symphony in Slang"), movies (The Fugitive, Mr. Holland's Opus, Witness, American President), television programs, and popular music to teach listening comprehension, vocabulary, pronunciation, and culture. **Audience:** K-12, Intensive English Programs

Catherine Hutcheson - MA, University of Tulsa; TESL, University of Texas, Arlington. ESL Director and Intensive English Instructor at Troy University, Troy, Alabama. E-mail: chutcheson@troyst.edu

Room 225 - Reading the ELL Classroom as Text Charlotte L. Pass, The University of Alabama

Most educators have had no training for their role as multicultural educators. As evidenced from pictures taken from classrooms and interviews of English language learners (ELLs), while they may be welcoming their students verbally, their classroom organization and the school structure may suggest otherwise. **Audience:** K-12

Charlotte Pass is a doctoral student at The University of Alabama hoping to begin dissertation work in the fall of 2004. E-mail: CPASS234@aol.com

Room 207 - Continuity in Foreign Language Learning From Third to Sixth Grades *Grace Chin-Wen Chien, Chung-Hu Elementary School*

Textbooks are selected every year. Students learn from one textbook for a year and another for next year. They might not learn words for production, words for recognition, sentences, and language functions. A continuing EFL curriculum is designed and aimed to help learners acquire obligatory English acquisition in elementary school. **Audience:** K-12

Grace Chin-Wen Chien got her Master's degree in Applied Linguistics and TESOL from Indiana University. She has been teaching English in elementary school for three years. Email: chinwenc@ms24.hinet.net

Loft - KEEPING IT REAL! *Terri Craft, Crystal Maness, Melissa Michael, University of North Alabama*

Authentic material and language are important aspects of L2 education. This interactive workshop will demonstrate three to four (depending on time) uses of authentic material and language across the basic curriculum of Reading, Grammar/Writing, Listening, and Speaking. Participants will be able to practice using authentic language and materials and discuss how these methods and techniques can be useful in their classrooms. Handouts will be available with additional methods and activities. **Audience:** K-12, Higher Education, Adult Education

Terri Craft, M.A. English, ESL Instructor at the University of North Alabama Center for English Language Learning. Melissa Michael, B.A. Spanish, B.A. Professional Writing, TESOL Graduate Certificate, ESL Instructor at the University of North Alabama Center for English Language Learning. Crystal Maness, B.A. Spanish, B. A. English, ESL Instructor at the University of North Alabama Center for English Language Learning. E-mail: tbcraft@una.edu; melissaaha@aol.com; lacrystalm@yahoo.com

Performance Center - I Have an Idea; Now Where Do I Get the Money?
Amanda Perry, University of North Alabama

Writing a grant sounds difficult, but it shouldn't intimidate teachers. This presentation will help you put grant writing in your comfort zone. When you leave, you'll want to get started on Monday! **Audience:** K-12, Higher Education, Adult Education, Intensive English Programs, Administration

Amanda Perry has taught college-level ESL since 2000. She has done grant writing for area arts organizations. E-mail: alperry@una.edu

Concurrent Session 3 - Saturday - 8:30 - 9:15 AM

Room 200 - Feed The Students' Souls In The Language Classroom With Music! *Seniz Bilgi, Middle East Technical University*

"Music is the food for the soul", so why shouldn't the teachers feed their students' souls? Isn't it possible to motivate learners or to teach a new grammar point or vocabulary through music? This workshop will answer these questions and exemplify how music can be used in language teaching. **Audience:** Higher Education, Adult Education, Teacher Education

Seniz Bilgi graduated from METU, Department of Foreign Languages Education, Ankara, Turkey. She has been an instructor at the same university for two years. Email: bseniz@metu.edu.tr

Room 225 - ACTFL Rubrics for Assessing Proficiency in Reading, Listening, Speaking, and Writing *Marie Miller-Whitehead, University of North Alabama*

This presentation shows how proficiency scales adopted and developed by the ETs and the American Council on Teaching of Foreign Language (ACTFL) may be useful in assessment of English Language Learners. The session will provide examples of several widely used scoring rubrics for comparison purposes and discuss populations for which each might be suitable. **Audience:** K-12, Higher Education, Research, Teacher Education

Marie Miller-Whitehead has taught EFL in Venezuela, has conducted bilingual training for a multinational corporation, and has published several articles and reviews on testing and assessment issues. She has designed assessments for Kindergarten, secondary, and college level students.

Room 207 - Assessing English Language Learners in ESL Or Mainstream Classrooms *Dr. Laureen A. Fregeau and Dr. Robert D. Leier, University of South Alabama*

Taking a test can be a very frustrating experience for an English Language Learner. Many students may know the content but are unable to do well on formal examinations. This mini-workshop will provide suggestions on how the teacher can assess ELLs in the ESL and Mainstream classrooms. Participants will learn how to modify existing tests for ELLs, how to prepare ELLs to take tests and how to incorporate other forms of assessments to determine student progress. **Audience:** K-Adults

Laureen A. Fregeau is an Associate Professor of Educational Foundations at the University of South Alabama. She prepares educators to work with diverse populations and has taught ESL to middle school, high school, and adult ELLs. Robert D. Leier is an adjunct professor of Educational Foundations at the University of South Alabama. He instructs undergraduate and graduate education students on how to serve immigrant and minority students in education. He has taught ESL at the 6-12 and adult levels. E-mail: rdleier@zebra.net, rleier@usouthal.edu, lfregeau@usouthal.edu

Loft - Avenues to Language and Literacy Success

Rebecca Gigliotti, Hampton-Brown Co.

Presenters will share specialized ESL strategies and hands-on activities for building background and vocabulary, working with literature to build comprehension skills and reading strategies, developing academic language and content area concepts, as well as helping to move students through language levels for meeting Adequate Yearly Progress mandates. **Audience:** Administration, Bilingual Education, Intensive English Programs, K-5 (Elementary)

Rebecca Gigliotti, Educational Consultant for Hampton-Brown, works extensively with educators of English Language Learners and Bilingual students to implement best practices in language/literacy development. E-mail: Rgigliotti@hampton-brown.com

Performance Center - Now What Do I Do? Practical Tips for Teachers of ELLs *Anna Pérez-Melvin, Russellville High School*

This presentation was designed to help teachers know where to begin when they find themselves teaching ELLs in their content areas. It gives a basic overview of the myths and

theories surrounding second language acquisition, and it offers practical advice and resources for use in the classroom. **Audience:** K-12, Administration, Teacher Education, ELL Teachers

Anna Pérez-Melvin currently teaches Spanish, English, and Drama at Russellville High School. She holds a Master's degree from the University of Alabama at Birmingham in ESL. E-mail: aperez@rcs.k12.al.us

Concurrent Session 4 - Saturday - 9:30 - 10:15 AM

Room 200 - HELPI Helping English Language Learners Progress

Vicki Davidson, Division Director/Title III State Director, Mississippi Department of Education

The topics discussed during this session will provide information on issues that impact the education of English language learners (ELLs). The goal of this session is to inform participants about appropriate approaches for providing a high quality education for ELL students. **Audience:** K-12 (Elementary and Secondary, Bilingual Education, Teacher Education)

Vicki Davidson currently serves as the Division Director of the Office of Reading, Early Childhood and Language Arts and the Title III/ELL Coordinator at the Mississippi Department of Education. After completing undergraduate studies in English at Tougaloo College, she continued graduate studies in English at Mississippi State University. She served as a secondary English teacher before beginning her position with the Mississippi Department of Education.

Room 225 - What Makes a Successful ELL Program *Marlynn Martin, Rankin County School District*

You ask the questions of the "ELL Wheel of Fortune" panelists. Participants with the best questions add up points to win big in learning how to create a successful ELL program. **Audience:** K-12, Administration, Teacher Education

Marlynn Martin currently serves as Assistant Director of Federal Programs in Rankin County School District, Brandon, Mississippi. She is pursuing her Ph.D. in Educational Leadership at Mississippi State University. E-mail - mkmartin@rcsd.ms

Room 207 - Walk a Mile in My Shoes: Teaching Tolerance in ESL

Dr. Susan Olmstead, University of Alabama, Huntsville

Inspired by collaboration with Uzbeki colleagues, this classroom activity encourages students to think deeply about how other people may be experiencing the world. Students learn to observe others, to consider possible motivations for behavior choices, and to express in first person statements what it might be like to be in the shoes of another. **Audience:** 7-12 grade secondary, higher education

Susan Olmstead has been teaching English and ESL in the States, and EFL in Taiwan since 1973. She researches second language medical writing and Mandarin-English code-switching. E-mail: olmst003@bama.ua.edu

Loft - Life is Full of Barriers. English Should Not Be One

Matt Adams, Darrell Adams, Dorothy Adams, Adams Learning Resources

Ellis: English Language and Instruction System Ellis: English Language Learning System is a software program featuring interactive instruction including video and voice recording capabilities which supports over 60 native languages. **Audience:** K-12, Higher Education, Adult Education, Intensive English Programs, Teacher Education

Darrell, Dorothy, and Matt Adams provide educational products and services for all subjects in all grade levels as well as conduct workshops and training for teachers on how to enhance student achievement through the use of software and technology. E-mail: dladams@hiwaay.net

Performance Center - What's In The Newspaper? *Sheryl Stewart, Hoover High School*

The newspaper is a creative way to teach ELL students. The Birmingham News has created a list of questions that address the Alabama English Language Acquisition Standards
Audience: Secondary Education (6-12), Adult Education, Teacher Education

Sheryl Stewart has three degrees in Early Childhood and Elementary Education and a background in English Language Learning and Reading. E-mail: ShStewart@hoover.k-12.al.us

Concurrent Session 5 - Saturday - 10:45 - 11:30 AM

Room 200 - Challenges facing ELLs based on their L1 writing systems *Susan Spezzini, University of Alabama at Birmingham*

Participants are led through several activities for identifying challenges facing ELLs based on L1 writing systems. Special emphasis will be placed on learning about writing systems that are very different from the one used in English. Participants will actually write some words in Chinese, Japanese, Korean, Arabic, Hindi, and Greek. **Audience:** K-12, Higher Education, Adult Education, Bilingual Education, Intensive English Programs, Teacher Education

Susan Spezzini directs Project EQUAL, an ESL certification program, at the University of Alabama at Birmingham. She also teaches courses in linguistics, phonology, and grammar. E-mail: spezzini@uab.edu

Room 225 - Working with ELL Students in the Mainstream Classroom *Carol Behel, Florence City Schools (K-9)*

This presentation will take a closer look at the challenges that ELL students experience in the general education classroom and offer practical solutions to the general content teacher to accelerate the learning of these students and help them become successful students in the general education classroom. **Audience:** K-12, Administration, Teacher Education

Carol Behel holds an Educational Specialist degree in ESL/Bilingual Education from the University of Alabama. She enjoys working with her ELL students at both elementary and secondary levels. E-mail: cabehel@fcs.k12.al.us

Room 207 - Fundamentals of Grant Writing *Priscilla Holland, Ed.D., University of North Alabama*

The who, what, where and how of grant writing. How to prepare a concept paper, where to find potential sponsors, who and what is important in preparing a grant application/proposal. **Audience:** General

Priscilla Holland is Director of Research, Planning and Institutional Effectiveness and Assistant Professor of Geography at the University of North Alabama. She has conducted numerous workshops on grant writing for k-12 teachers, UNA Faculty, the George Lindsey/UNA

Television and Film Festival and has coordinated Sponsored Programs at UNA since 1992.
E-mail: apholland@una.edu

Loft - What Everyone Needs to Know About Recruiting

Alan L. Webb, The University of Alabama at Gadsden

Successful Intensive English Programs share three common characteristics: Discipline, Focus, and Creativity. See how this is accomplished and learn about specific techniques that you can employ in your language institute. **Audience:** Research, Higher Education, Administration, Intensive English Programs, Teacher Education

Alan Webb recently graduated from Shenandoah University with his master's degree in TESOL. His thesis was entitled "Marketing and Recruiting for the IEP." E-mail: webb81357@yahoo.com

Performance Center - Teaching Uncountable Nouns to Portuguese

Speakers

Eve Ribeiro, Georgia State University

This presentation talks about the pedagogical implications of teaching uncountable nouns to Portuguese speakers receiving EAP instruction in ESL or EFL settings. Results indicate that EAP students have certain types of errors which should be prioritized in instruction. The practical applications of findings are also addressed. Handouts will be available **Audience:** Adult Education, Intensive English Programs

Eve Ribeiro taught adults in Brazil and was an exchange teacher in the U.S. He is now an Applied Linguistics graduate student at GSU. E-mail: everibeiro@hotmail.com

Concurrent Session 6 - Saturday - 11:45 AM - 12:30 PM

Room 200 - Latest & Greatest from Oxford University Press

Cindy Tracy, World of Reading – Ala. Rep. for Oxford University Press

Let me share some of Oxford's latest and greatest products – such as high interest Readers for both the Oxford Picture Dictionary for Kids and the Oxford Picture Dictionary for the Content Area, the Oxford ESL Dictionary and Genie CD-ROM and more! **Audience:** K-12, Higher Education, Intensive English Programs

Cindy Tracy is the President of World of Reading in Atlanta and has served as the Alabama rep for Oxford University Press for 5 years. E-mail: polyglot@wor.com

Room 225 - WIDA Standards and Assessments for English Language Learners in Kindergarten through Grade 12 *Dely Velez Roberts, Alabama Department of Education, Title III Coordinator*

Dely Velez Roberts will provide an overview of the No Child Left Behind Act of 2001 with an emphasis on Title III. She will bring you up-to-date on what Alabama is doing to meet the requirements of Title III with emphasis on our newly adopted WIDA Standards and Assessment. This session will be very informative and valuable for anyone who currently or may in the future, deal with English Language Learner Students and Title III. **Audience:** K-12, Higher Education, Teacher Education

Dely Velez Roberts is the Title III Coordinator for the Alabama Department of Education. Dely is from Alabama and has a vast amount of experience both professionally and personally with English Language Learners. **E-mail:** droberts@alsde.edu

Room 207 - Word length effect on the retrieval process of L2 writing Tony Becker, Georgia State University

This study analyzes writing procedures of 30 NNS of English. Their hand movements were taped, and writing pauses were recorded. Chinese writers had more difficulty writing longer English words. Such findings are interesting, given that the pauses weren't due to the alphabetic relationship found between English, Spanish, and Arabic languages. **Audience:** Research

Tony Becker is a master's student at Georgia State University, in the Department of Applied Linguistics. He is interested in the areas of psycholinguistics and sociolinguistics.

Loft - Teaching English While Learning Different Cultures
Cagri, Bagcioglu, Tugrul Polat, Millie Nelson, University of North Alabama

Cultures affect the ability and the concept of learning a new language. Some languages are strictly connected to different cultures. This presentation will talk about most common mistakes made in teaching ESL caused by cultural differences and some useful tips to overcome fears. **Audience:** K-12 (Elementary and Secondary), Higher Education, Intensive English Programs, Administration

Cagri Bagcioglu: Director of International Student Services, University of North Alabama. Tugrul Polat: Coordinator of Special Programs and NCN Project, University of North Alabama. Millicent Nelson: Specialist/International Student Services, University of North Alabama. E-mail: mmnelson@una.edu

Performance Center - What did you say? Analyzing Discourse in Listening/Speaking Classrooms Alice Cook, University of North Alabama

Often ESL textbooks do not provide accurate representations of the language students will encounter in the English-speaking community. Students need to be made aware of conversational conventions by being actively involved in researching authentic discourse. This presentation will show you how to use this method in your classroom. **Audience:** Higher Education, Adult Education, Intensive English Programs

Alice Cook received a BA in English and History from UNA and an MA in English with a TESOL certificate from UAH. She taught ESL at the University of Alabama in Huntsville and is now the Interim ESL Curriculum Coordinator at the University of North Alabama. E-mail: aecook@una.edu

Vendors

Cindy Tracy
Oxford University Press/World of
Reading Ltd.
P.O. Box 13092
Atlanta, GA 30324
Phone - 404-233-4042 or 800-729-
3703
E-mail - polyglot@wor.com

Darrell Adams
Adams Learning Resources, LLC
338 Highland Park Drive
Birmingham, AL 35242
Phone 205- 980-2506 or 800-644-
4995
E-mail - dladams@hiwaay.net

Alta Book Center Publishers
Jamie Ann Cross, Editor
14 Adrian Court, Burlingame, CA
94010
Phone - 800- ALTA ESL
e-mail - jamie@altaesl.com
Website: www.altaesl.com

Ruth Smith
Usborne Books
2213 Kenbridge Circle
Birmingham, AL 35226
Phone 205-979-7993 or 888-565-
5828
E-mail - RS4books@aol.com

Roberta Croll
Fulbright Teacher Exchange
Program (representative - Debora
Martin)
600 Maryland Ave., SW Suite 320
Washington, DC 20024
Phone - 202-314-2527
E-mail - fulbright@grad.usda.gov
Website -
www.fulbrightexchanges.org

Toni Shay
Lex Ami
2290 County Road 478
Clanton, AL 35046
Phone - 800-607-5692
E-mail - LexAmiToni@aol.com

😊 Special Thanks 😊

Dr. Daniel Howard
International Student Services
University Events
Jayne Jackson

Cindy Ochoa - Next Generation TOEFL
UNA's College of Education

UNA's Center for English Language Learning

Greg Holt - Holt Screenprinting of Tuscumbia

University of North Alabama Bookstore

Kathryn King - Multilingual Matters

Elizabeth Claire - Easy English News

Molly Watkins

Julia Austin

Alice Cook

Dr. Laura Stokes

Cagri Bagcioglu

Kara Lindley Herron

Carol Behel

Cortez Dixon

Dr. Bill Foster

Margaret Allen

Charlotte Justice

Tugrul Polot

Millie Nelson

Amanda Perry

Roland Mann

Stephanie Brown

Crystal Maness

Suzanne Brackin

Melissa Michael

Kathryn McCrary

Carlene Blackburn

Reeda Lee Terri Craft

Chris Creel

Elise Holm

Jason Brown

... and last, but not least, Will Brown

FIRST FLOOR

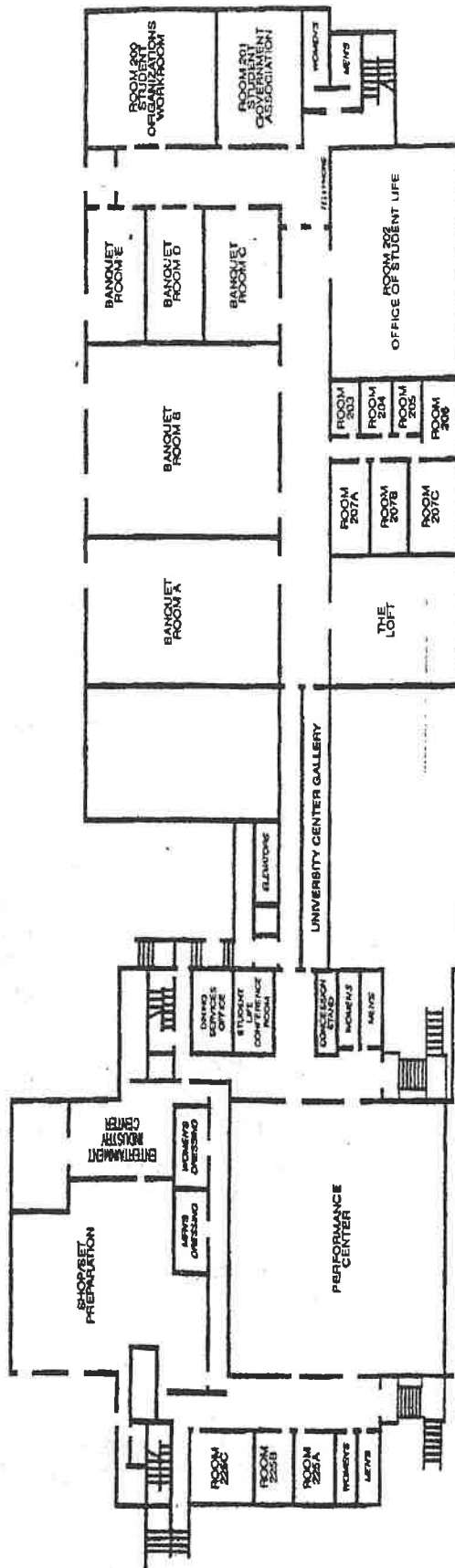

The 39th Annual TESOL Convention and Exhibit

TESOL 2005

Teaching Learning,
Learning Teaching

A NEXUS IN TEXAS

March 30 - April 2, 2005

San Antonio, Texas USA

Sessions will be held at the
Henry B. Gonzalez
Convention Center.



**The Premier Professional Development Event
for ESL/EFL Educators**

More than 170 exhibitors and distinguished speakers

Offering hundreds of sessions, numerous networking opportunities,
and speakers from around the world

For details, go to TESOL's Web site at <http://www.tesol.org/>
or e-mail conventions@tesol.org

Teachers of English to Speakers of Other Languages, Inc. (TESOL)
Tel. 703-836-0774 • Toll free 888-547-3369

Get certified to teach English as a Second Language in grades P-12

The University of North Alabama has developed an ESL certification program to help meet the needs of our growing school districts. In order to be certified as an English as a Second Language teacher, the candidate must:

1. Meet certification requirements in elementary education or secondary education in another content area.
2. Complete the following five courses:

FL 302	Cross-Cultural Conflicts	
EN 306	Introduction to English Linguistics	OR
EN 441	History of the English Language	
EN 442	English Grammar	
ED 340	Introduction to Teaching English as a Second Language	
ED 380	Methodology and Assessment of Teaching English as a Second Language	
3. Complete an internship teaching English Language Learners.

For more information, please contact Dr. Joy Brown - (256) 765-4837 or jmbrown@una.edu